



GRIMAUD IMMO
Real Estate

365 000 €

Buying land

Surface : 900 m²

Field appearance : flat

Exposure : Sud ouest

View : Collines et jardin

Benefits :

Clôturé

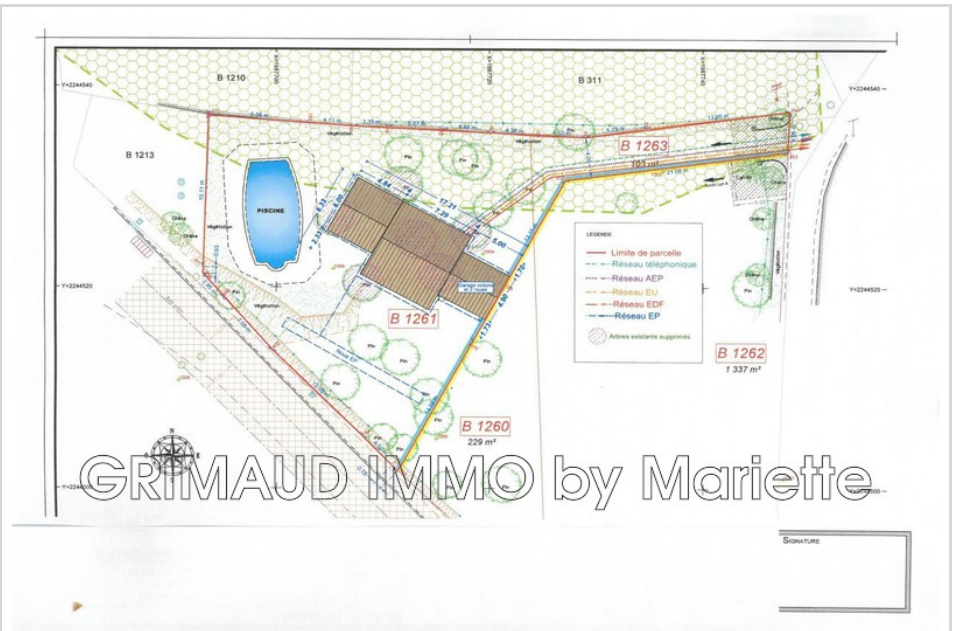

Land 926 Le Plan-de-la-Tour

Building land with cleared building permit, within walking distance of the village, serviced with a surface area of 900m². The permit for a house with an upper floor consisting of: living room, open kitchen, master bedroom with bathroom, dressing room and garage and upstairs 3 bedrooms with 1 bathroom. In the garden, existing swimming pool to be renovated.

Fees and charges :

365 000 € fees included

Document non contractuel

02/05/2024 - Prix T.T.C

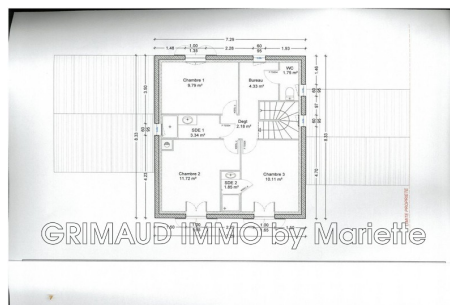
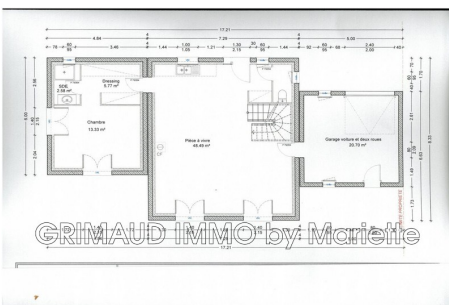

GRIMAUD IMMO by Mariette - Place vieille/Angle rue des Meuniers - 83310 Grimaud

Tél: +33 (0)4 94 43 23 23 - grimaudimmo@gmail.com

Carte professionnelle n°CPI 8304 2019 000 041 585 délivré par le CCI de Var - RCS 851563163 Fréjus

SIRET 85156316300019 - Garantie financière : Vallois, 110 000 € - Document non contractuel - *prix F.A.I.